

Palestine Grove Colliers Wood, SW19 2QN

£475,000 Freehold



Beautifully presented two double bedroom Victorian end of terraced family home located a short walk to Colliers Wood tube station and high street. Through lounge with solid oak flooring, open plan living. Downstairs W/C. Stunning modern kitchen with fitted appliances and stone worktops. Attractive rear garden with patio and lawn. Generous bedrooms. Modern bathroom suite. Located on a quiet residential street close to good transport links.

Palistine Grove, SW19

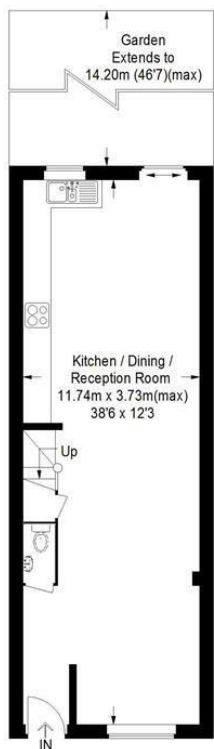

Ground Floor

Approximate Gross Internal Area
Ground Floor = 45 sq m / 484 sq ft
First Floor = 34 sq m / 366 sq ft
Total = 79 sq m / 850 sq ft

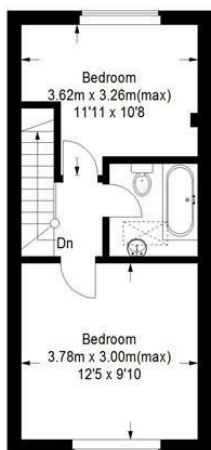

First Floor



This floor plan is for representation purposes only and is not drawn to scale. Whilst every attempt has been made to ensure its accuracy measurements are approximate only and should be checked before making any decisions reliant upon them.
Copyright Bespokeplans.co.uk 2016
(ID302962)

- Victorian End Terrace
- Stone Worktops in Kitchen
- Solid Oak Flooring
- Well Presented Throughout
- Close to Good Transport Links
- EPC Rating D

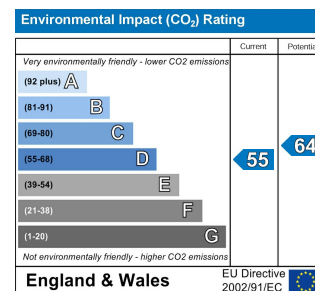
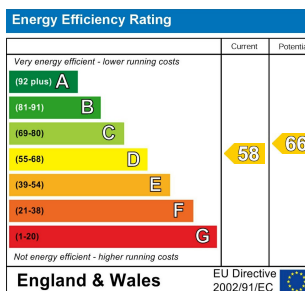

For Free Mortgage Quote and Best Mortgage Rates, call an Ellisons Mortgage Advisor on 020 8544 0518

Although these particulars are believed to be correct, their accuracy is not guaranteed and they do not form part of any contract.

Ellisons Estate Agents Limited

Registered Office: 4th Floor, Tuition House, St. George's Road, Wimbledon, London SW19 4EU. Registered in England & Wales, company number 7533420